

PO: _____ **Date:** _____ **Customer #:** _____

Customer Name: _____ Ship To Name: _____
 Address: _____ Address: _____
 Phone: _____ Phone: _____
 Contact: _____ Contact: _____
 Email: _____ Tag: _____



(shown with optional upgrades)

| Standard Features | |
|-----------------------------------------------------------|---------------------------------------------|
| • 250lb Maximum Occupant Weight (rocking) | • Rocking Mechanism (for up to 33° of tilt) |
| • 350lb Maximum Occupant Weight (non-rocking) | • Seat Mount Lower Leg Support Assembly |
| • Tubular Steel, Powder Coated Frame | • 2 x 20" Front Mag wheels |
| • Adjustable Seat Surface Height | • 2 x 5" Total Lock Rear Caster Wheels |
| • Independent Adjustable Arm Support Height | |
| • Up to 25° Infinitely Adjustable Seat Tilt (non-rocking) | |
| • Up to 33° Infinitely Adjustable Seat Tilt (rocking) | |

Encore Pedal Wheelchair® - Model: 48V4/48RV4 (E1161) MSRP \$3,254

*Prices shown are Broda suggested retail prices only and are rounded to the nearest dollar. Dealers set their own prices. Please contact Broda or consult your selected dealer for details.

WC19 Transit Tie Down Vehicle Package* - Factory Installed Only, 300lb Maximum Occupant Weight \$315

*Available up to 24" seat width and front mag wheels only.

Seat and Back Support Options

| | | | |
|------------------------------------|-----------------------------------------------------------------------------------------|------------------------|-------------------------------------------------------------------------------------|
| Rocking Mechanism: | <input type="radio"/> Eliminate Rocking Function -\$325 | Seat Depth: | <input type="radio"/> 17" Standard |
| | | | <input type="radio"/> 18.5" N/C |
| Seat Width: | <input type="radio"/> 16" <input type="radio"/> 18" <input type="radio"/> 20" N/C | | <input type="radio"/> 20" \$103 |
| | <input type="radio"/> 22" \$431 | Standard Back | <input type="radio"/> 32" Standard |
| Non-Rocking Only | <input type="radio"/> 24" <input type="radio"/> 26" \$975 | Support Height: | <input type="radio"/> 33.5" \$103 |
| | <input type="radio"/> 28" \$975 | | <input type="radio"/> 35" \$103 |
| Seat Surface Height Rocking | <input type="radio"/> 15" Standard | Short Back | <input type="radio"/> 22" (does not include) -\$412 |
| | <input type="radio"/> 14" <input type="radio"/> 16" <input type="radio"/> 17" N/C | Support Height: | Adjustable Lateral Shoulder Supports and Assembly, Neck Support Option - see page 2 |
| | <input type="radio"/> 18" <input type="radio"/> 19" N/C | | |
| Seat Surface Height No Rock | <input type="radio"/> 12.5" <input type="radio"/> 13.5" <input type="radio"/> 14.5" N/C | | |
| | <input type="radio"/> 15.5" <input type="radio"/> 16.5" <input type="radio"/> 17.5" N/C | | |

Front Options

Wheel Options

Rear Options

| | | | |
|---------------------------------------------|----------|--------------------------------------------------------------|----------|
| <input type="radio"/> 20" Mag Wheels - Pair | Standard | <input type="radio"/> 5" Total Lock Caster Wheels - Pair | Standard |
| <input type="radio"/> 22" Mag Wheels - Pair | N/C | <input type="radio"/> 5" Aluminum Non-Locking Caster Wheels* | \$196 |
| | | *(available with front mags only) | |

| | | | |
|--------------------------------------------------------------|--------|-----------------------------------------------------------------|--|
| <input type="radio"/> 5" Total Lock Caster Wheels - Pair | -\$571 | <input type="radio"/> 5" Fixed Non-Locking Caster Wheels - Pair | |
| <input type="radio"/> Parking Brake Extension Handles (pair) | \$66 | | |

Arm Support Options

| | | | |
|--------------------|---------------------------------------------------------|--------------------|----------------------------------------------------------------------------|
| Arm Support | <input type="radio"/> Arm Support - Pair Standard | Arm Support | <input type="radio"/> Height Adjustable - Pair Standard |
| Cushion | <input type="radio"/> Arm Support Trough - Each \$140 | Style: | <input type="radio"/> Height and Depth Adjustable - Pair \$142 |
| Options: | <input type="radio"/> Cushioned Arm Support - Pair \$82 | Arm Mount | <input checked="" type="radio"/> Seat Mounted Arm Supports - Pair Standard |

Seating and Frame Color Options

| | | | |
|------------------------|-------------------------------------------------|----------------------|-------------------------------------------------------------------------------------------------------|
| Comfort Tension | <input checked="" type="radio"/> Black Standard | Frame Colors: | <input type="radio"/> Black <input type="radio"/> Deep Orange N/C |
| Seating Color: | | | <input type="radio"/> Tungsten Sand <input type="radio"/> Bronze |
| | | | <input type="radio"/> Carmine Red <input type="radio"/> Ocean Blue <input type="radio"/> Satin Nickel |

Upholstery Style Options (Select one)

| | | | | |
|----------------------------|-------------------------------------------|---------------------------------------------|---------------------------------------------|-------|
| Accent Color Vinyl: | <input type="radio"/> Interlace Indigo*** | <input type="radio"/> Interlace Espresso*** | <input type="radio"/> Interlace Graphite*** | |
| | <input type="radio"/> Savoy Black | <input type="radio"/> Inclination Lake | <input type="radio"/> Inclination Smoke | |
| Vinyl: | <input type="radio"/> Beeline Portobello | <input type="radio"/> Beeline Geyser | <input type="radio"/> Beeline Forge | N/C |
| Nylon: | <input type="radio"/> Digital Camo | <input type="radio"/> Retro Camo Jungle | | \$134 |

Upholstery Colors come with seat and back cushions in black vinyl. *Interlace Indigo, Espresso, and Graphite available with seat and back cushions in matching vinyl color

Cushions - Choose Option 1, 2, OR 3

| | | |
|-----------------------------------------------------------------------------------------------------------------------------|---------------------------------------------------------------------------------------------------------------------------------------------------|----------|
| <input type="radio"/> Option 1 - Broda Standard Cushions | | N/C |
| Includes: Neck Support, Adjustable Lateral Shoulder Supports, Lower Side Covers, Seat and Back Support Cushions with Covers | | |
| Seat & Back Pad Cover | <input type="radio"/> Black Vinyl | Standard |
| Options: | <input type="radio"/> Accent Color ***Option For Interlace: Indigo, Espresso or Graphite only (Select Black Vinyl OR Accent Color Vinyl Above) | N/C |
| | <input type="radio"/> Full Vinyl Wrap Seat and Back Support Cushions (Select Black Vinyl OR Accent Color Vinyl Above) | \$103 |
| | <input type="radio"/> Grey Terry Cover <input type="radio"/> White Terry Cover | N/C |
| Lateral Shoulder Support | <input type="radio"/> Lateral Shoulder Supports - Pair | N/C |
| Options: | <input type="radio"/> Long Lateral Shoulder Supports - Pair | \$142 |

Optional Substitutions Available Between APP & SPP Package Cushion Components

| | | | |
|----------------------------------------------------------------------------------------------------------------------------------------------------------------------------------------------------------------------------|-------------------------------------------------------------------------------|--------------------------------------------------------------------------------------------------------------------------------------------------------------------------------------------------------------------------------------------------------------|-------|
| <input type="radio"/> Option 2 - Broda Additional Positioning Padding (APP), 24"-28" seat widths for non-rocking only | | | |
| Broda APP Package Includes: Seat, Back and Head Support Cushions (no Head Support or Lateral Shoulder Supports on short back), plus Adjustable, Removable Lateral Shoulder Supports and Lateral Upper Leg Support Cushions | | | |
| Seat Width: | <input type="radio"/> 16" <input type="radio"/> 18" <input type="radio"/> 20" | Seat Depth: <input type="radio"/> 17" <input type="radio"/> 19" <input type="radio"/> 21" <input type="radio"/> 17" <input type="radio"/> 19" <input type="radio"/> 21" <input type="radio"/> 17" <input type="radio"/> 19" <input type="radio"/> 21" | \$379 |
| | <input type="radio"/> 22" <input type="radio"/> 24" | | \$593 |
| | <input type="radio"/> 26" <input type="radio"/> 28" | | \$702 |

| | | | |
|--------------------------------------------------------------------------------------------------------------------|---------------------------------------------------------------------------------------|----------------------------------------------------------------------------------------------------|--------------------------------------------------------------------------------------|
| <input type="radio"/> Option 3 - Broda Slim Posture Padding (SPP), 24"-26" seat widths for non-rocking only | | | |
| Broda SPP Cushion Options: Seat, Back Support, and Back Support Extension Cushions | | | |
| Seat Width: | <input type="radio"/> 16" <input type="radio"/> 18" <input type="radio"/> 20" | Seat Depth: <input type="radio"/> 17" <input type="radio"/> 18.5" <input type="radio"/> 20" | \$136 |
| | <input type="radio"/> 22" <input type="radio"/> 24" | <input type="radio"/> 17" <input type="radio"/> 18.5" <input type="radio"/> 20" | \$150 |
| | <input type="radio"/> 26" | <input type="radio"/> 17" <input type="radio"/> 18.5" <input type="radio"/> 20" | \$174 |
| Lower Back Support | <input type="radio"/> 16" <input type="radio"/> 18" <input type="radio"/> 20" \$120 | Upper Back Support | <input type="radio"/> 16" <input type="radio"/> 18" <input type="radio"/> 20" \$90 |
| | <input type="radio"/> 22" <input type="radio"/> 24" \$144 | Support | <input type="radio"/> 22" <input type="radio"/> 24" \$100 |
| 13" Height | <input type="radio"/> 26" \$174 | 12" Height | <input type="radio"/> 26" \$110 |

Matrx® Head Support (Available with 22" Short Back Option Only)

| | | |
|-------------------------------|--------------------------------------------------------------------------------------------------------------------------------|-------|
| Head Support Mounting: | <input type="radio"/> Elan Head Support Hardware - Required with Selection of Head Support | \$220 |
| Support Options: | <input type="radio"/> Elan Head Support Cushion <input type="radio"/> 10" <input type="radio"/> 14" \$235 | |
| | <input type="radio"/> Elan Head Support 4 Point Cushion <input type="radio"/> 9" x 7" <input type="radio"/> 11" x 10" \$325 | |
| | <input type="radio"/> Elan Head Support with 4 Point Cushion <input type="radio"/> Small <input type="radio"/> Large \$450 | |

Drop In Style Must Choose One Lower Leg Support Assembly Style Pin and Saddle Style

| | | | |
|------------------------------------------------------------------|-----|-------------------------------------------------------------------------|-----|
| <input type="radio"/> Lower Leg Support Assembly (Drop-in)- Pair | N/C | <input type="radio"/> Lower Leg Support Assembly (Pin & Saddle) - Pair* | N/C |
|------------------------------------------------------------------|-----|-------------------------------------------------------------------------|-----|

*Pin & Saddle Lower Leg Support Assembly not available with 16" SW chair due to overlapping foot supports

Must Choose One Seat Mount Lower Leg Support Assembly Location

| | | | |
|-----------------------------------------|-----|----------------------------------------------|-----|
| <input type="radio"/> Seat Frame Mount* | N/C | <input type="radio"/> Sub-Seat Frame Mount** | N/C |
|-----------------------------------------|-----|----------------------------------------------|-----|

*Not available on rocking version with 17" seat depth

**Improves the ease of the rocking mechanism

*Not available on non-rocking version when choosing 12.5" seat surface height with pin & saddle style lower leg support assembly

Seat Frame Mount



Sub-Seat Frame Mount

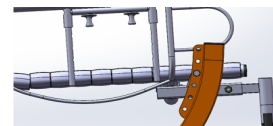



Drop-In Style

Lower Leg Support Options

Pin & Saddle Style

| | |
|-------------------------------------------------------------------------------------------------------------------------------------------------------|------------------------------------------------------------------------------------------------------------------------|
| <input type="radio"/> F-SW-IKN: Swing Away Lower Leg Supports Silver - Pair \$98 | <input type="radio"/> F-SW: Swing Away Lower Leg Supports Black- Pair \$157 |
| <input type="radio"/> F-SW-ELV-IKN: Elevating Swing Away Lower Leg Supports \$407 Silver Aluminum w/ Angle Adjustable Flip-up Foot Supports - Pair | <input type="radio"/> F-SW-ELV: Elevating Swing Away Lower Leg Supports \$210 Black w/ Flip-up Foot Supports - Pair |
| <input type="radio"/> F-SW-IKN-ADJ: Swing Away Lower Leg Supports Black \$201 Steel w/ Adjustable Flip-up Foot Supports - Pair | <input type="radio"/> LEG-FOOT-ENCORE: Lower Leg Support Foot Board \$245 |
| | <input type="radio"/> LEGPANEL-ENCORE: Lower Leg Support ABS Cushions \$82 |

Common Accessories

| | | | | |
|----------------------|------------------------------------------------------|----------------------------------------------------------------------------------------------------------------------|-----------------------------------------------------------------------|-------|
| Head | <input type="radio"/> NR-CV | Head Support Visco Foam Contoured Cushion | <input type="radio"/> Omit Standard Head Support Less \$43 | \$109 |
| Supports: | <input type="radio"/> NS | Neck Support | | \$109 |
| Positioning | <input type="radio"/> SR | Lateral Support Reduction Cushions - Pair | | \$103 |
| Supports: | <input type="radio"/> CC-LTS | Comfort Company Lateral Supports - Pair | | \$486 |
| | <input type="radio"/> LTS | Lateral Torso Supports (<i>FACTORY INSTALLED RECOMMENDED</i>) | | \$597 |
| Pelvic Belts: | <input type="radio"/> S-BELT | Pelvic Belt | <input type="radio"/> Center Buckle <input type="radio"/> Side Buckle | \$54 |
| | <input type="radio"/> S-BELT-A | Pelvic Belt Auto Buckle | <input type="radio"/> Center Buckle <input type="radio"/> Side Buckle | \$54 |
| | <input type="radio"/> S-BELT-PD | Pelvic Belt Cushioned | | \$78 |
| | <input type="radio"/> S-BELT-PD-A | Pelvic Belt Cushioned and Auto Buckle | | \$78 |
| Thigh Belts: | <input type="radio"/> T-BELT | Thigh Belt Cushioned | | \$126 |
| | <input type="radio"/> T-BELT-A | Thigh Belt Cushioned and Auto Buckle | | \$130 |
| | <input type="radio"/> T-BELT-NEO | Thigh Belt Cushioned Neoprene | | \$126 |
| | <input type="radio"/> T-BELT-NEO-A | Thigh Belt Cushioned Neoprene and Auto Buckle | | \$130 |
| | <input type="radio"/> T-BELT-NEO-APP | Thigh Belt Cushioned Neoprene for APP & SPP Packages | | \$126 |
| | <input type="radio"/> T-BELT-NEO-A-APP | Thigh Belt Cushioned Neoprene Auto Buckle for APP & SPP Packages | | \$130 |
| Trays: | <input type="radio"/> TRAY-ABS | Tray ABS with Strap <input type="radio"/> Sewn Tray Strap <input type="radio"/> Grey <input type="radio"/> Black | | \$321 |
| | <input type="radio"/> TRAY-ABS-OVR | Tray ABS with Strap (24" - 28" width) <input type="radio"/> Black Only | | \$461 |
| | <input type="radio"/> TRAY-CLEAR | Tray Clear with Strap <input type="radio"/> Sewn Tray Strap | | \$332 |
| | <input type="radio"/> TRAY-HALF | Half Tray (<i>side specific</i>)(includes lower side cover) <input type="radio"/> Grey <input type="radio"/> Black | | \$441 |
| | <input type="radio"/> TRAY-COVER | Tray ABS Cushion Cover | | \$163 |
| Other: | <input type="radio"/> IV-POLE | IV Pole & Assembly <input type="radio"/> Front or <input type="radio"/> Rear Mount | | \$103 |
| | <input type="radio"/> O2-HOLDER | Oxygen Holder & Assembly <input type="radio"/> Front or <input type="radio"/> Rear Mount | | \$173 |
| | <input type="radio"/> STABIL-FR | Rear Stabilizer Frame | | \$93 |
| | <input type="radio"/> ACCESSORY-BAG | Accessory Bag (Black) Each | | \$41 |
| | <input type="radio"/> BAG PERSONALIZING (2 Initials) | <input type="radio"/> Brush Font <input type="radio"/> Block Font | | \$26 |
| | <input type="radio"/> CUP-HOLDER | Cup Holder (not compatible with front mounted mag wheel) | | \$46 |

Additional Options: _____

Delivery Instructions or Special Requests: _____

Total: \$

Accessorial Services: Each with an additional charge, are available to accommodate the delivery needs of Broda customers and/or the needs of a shipment's final delivery location. **To ensure a seamless delivery of each Broda order, any accessorial services needed to deliver are requested when an order is submitted to Broda.**

- Lift Gate Service:** Delivery is made with a lift gate trailer that moves the shipment from trailer level to ground level
- Residential Delivery Service:** Delivery to a residential location
- Notification Before Delivery:** Contact is requested to the Consignee by the Carrier PRIOR to shipment delivery
- Inside Delivery Service:** Movement of the shipment beyond the unloading position, i.e. move closer to a door, inside a building, upstairs, down a hall, etc. Price is specific per order, based on the customer's inside delivery needs
- Limited Access Service:** Delivery locations that are not open to the walk-in public, during normal business hours. Mon-Fri. 8a-5p



Encore Pedal Wheelchair Model: 48V4/48RV4

US MSRP Order Form
February 2021

Expedited delivery is available by customer request at the time of order, which is priced per order and is based on the delivery location and level of service.